



NJORD  
MARINE  
柏通海事



VENTUS  
MARINE  
峰達海運

## TECHNICAL SPECIFICATIONS

# 36M SERVICE ACCOMMODATION TRANSFER VESSEL



BV: I HULL MACH Wind farms service ship - M0 - Sea Area 2  
CR: CR100+ Aluminium Alloy Hull, Crew Boat, LSC, Catamaran,  
Greater Coastal Service (max. 150nm Hs 3.0m) , CMS+

PLAN VIEW BRIDGE

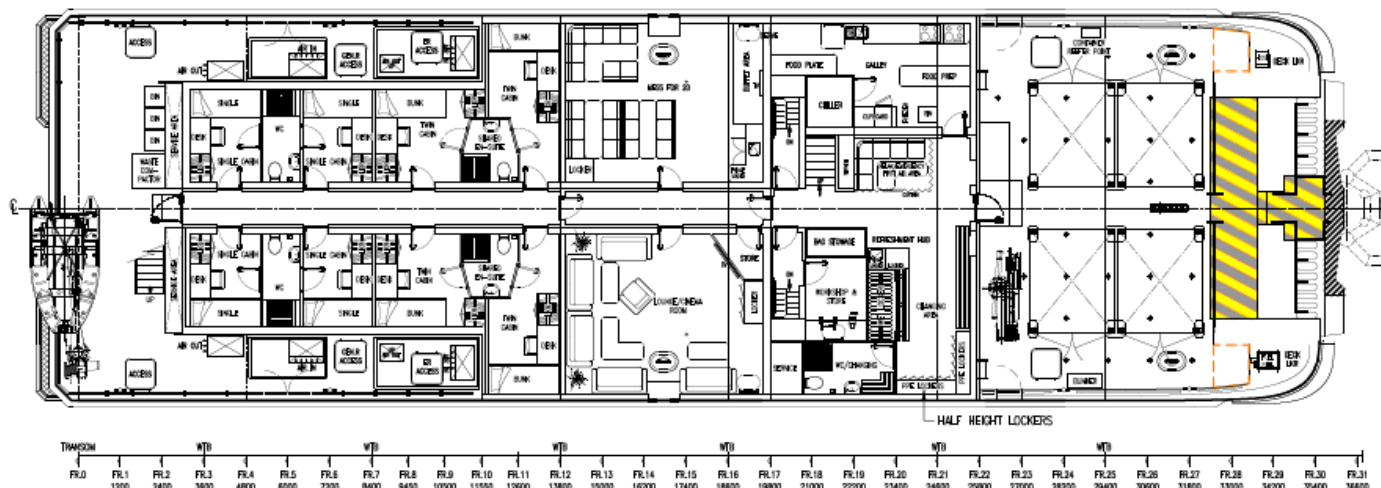

PLAN VIEW ON MAIN DECK

Njord Marine Co., Ltd, No. 622, Sec5 Lingang Rd Qingshui Dist Taichung 436040 Taiwan R.O.C  
chartering@ventusnjord.com | Tel + 886 4 2656 7015|



## OVERVIEW

Length Overall:	36.10 m
Length B.P:	34.56m
Breadth:	11.0 m
Depth:	4.80 m
Maximum Draft:	2.31 m
Gross Tonnage:	492 GT
Dead Weight:	67t
Main Engines:	2 x MTU 16B 2000 M72 2 x 1440kW x 2250 RPM
Aux Engines:	2 x CAT C7.1 27kW @1500 rpm 1,150 EKV, AC415V
Propulsion:	2 x CPP
Bow Thrusters:	2 x 85hp

Fwd Deck: 50m2  
Aft Deck: 10m2  
Loading: 2t/m2  
10ft & 20ft Container Points  
Multiple Tie Down Points

15 Single and 4 Twins cabins with  
dedicated/shared En-suite toilet/shower facilities  
for 12 Passengers and 10 crew

Fuel Oil:	65,000 litres
Fresh Water:	4,800 litres

Service Speed (light):	16 kts @ 80% MCR
Sprint Speed (light):	17.5 kts @ 90% MCR
Max Speed:	21 kts @100% MCR

Fuel Transfer System (Including 40m deck reel)  
Hydraulic Driven 150 bar High Pressure Washer  
Crane  
Make/Model: Palfinger / PK12000M  
Lifting Capacity: 1T @ 9m  
Maximum Outreach: 10m

EPIRB, Rescue Area Control Systems, Sea Marshall  
MOB Finder, Matesaver & MOB Davits MDM CM-  
52R-LR, Rescue Areas, Narwhal SV-42 Inflatable  
Rescue Boat

- Active Bow Fender System III
- Intercom covering all areas incl. engine room
- CCTV covering all areas incl. engine room
- Flir Thermal Camera
- Flood Lighting & Search Lighting
- Dive Platforms
- Lifting Lugs
- Fresh Water Maker
- Ride Control System (Sea Motion Control)
- Workshop space with working table and part racks
- Vessel Motion Monitoring System
- Waste Compactor
- Sewage Treatment System
- Provision of safe means of embarkation/disembarkation access using a gangway

Additional seating (sofa style) and communal table area  
Executive reclining seats with international sockets  
LCD TVs with DVD  
Lounge with entertainment unit  
Noise/vibration insulation  
Changing area and drying storage area  
13 x WCs; 13 x Showers  
Full galley incl. instant hot water and combi oven  
Gymnasium

Radar; ECDIS; ECS; Navtex; Autopilot;  
AIS; SART/Magnetic Compasses; 4 X VHF (3  
handheld); 1 X UHF Radio, Inmarsat;  
Speedlog; Wifi 4G Network