



### PRINCIPAL PARTICULARS

Year Built	: 2021
Builder	: Cheoy Lee Shipyard Ltd
Designer	: Robert Allan Ltd
Class	: Lloyd's Register of Shipping ✕ 100A1 Tug, Escort Tug Protected Waters Service, Fire-Fighting Ship 1 (2400m <sup>3</sup> /h) with Water Spray ✕ LMC UMS, *IWS, LMC,UMS
Flag	: Singapore
Call Sign	: 9V7474
IMO No.	: 9892860

### DIMENSIONS

Length Overall	: 25.40m
Breadth Moulded	: 11.80m
Depth Moulded	: 4.60m
Design Draft	: 3.40m (from baseline)
Navigational Draft	: 5.42m (max)
Gross Tonnage	: 348
Net Tonnage	: 104

### MACHINERY (INSTALLED WITH CCTV SYSTEM)

Main Engines	: 2 x 1999kW Caterpillar 3516C @ 1600rpm
Generators	: 2 x 118 kW Caterpillar C7.1
Propellers	: 2 x Schottel SRP 460 FP
Air Compressors	: 1 x Deno 2L-15/150

### ACCOMMODATION (FULLY AIR-CONDITIONED)

Officers	: 2 x1 berth
Crew	: 3 x 2 berths
Total	: 8 berths (MLC 2006 compliance)
Sewage System	: Taiko Kikai SBH

### FIREFIGHTING/ANTI-POLLUTION EQUIPMENT

FiFi Pump (PTO from Port M/E)	: 1 x FFS SFP 300x400PC of cap 2850m <sup>3</sup> /hr @ 119m head c/w water curtain
FiFi Monitor	: 2 x FFS 1200/300 dual purpose foam/water of cap 1200m <sup>3</sup> /hr @ 10 bar
Oily Water Separator	: Taiko Kikai USH-05
Oil Dispersant System	: Tetra Fire, Off-Center Spray VeeJet nozzle type (P&S)

### PERFORMANCE DATA

Speed @ 100%MCR	: 12.94 knots
Bollard Pull (Ahead)	: 70.82 tonnes
(Astern)	: 68.51 tonnes

### TANK CAPACITIES

Fuel Oil	: 91.4m <sup>3</sup>
Freshwater	: 12.3m <sup>3</sup>
Dispersant	: 5.0m <sup>3</sup>
Foam	: 5.0m <sup>3</sup>

### TOWING AND DECK EQUIPMENT

Tow Winch / Anchor Windlass (FWD)	: MacGregor Hydraulic Anchor Windlass / Escort Towing Winch, hydraulic single split drum, two chain wheels & one warping head type
Rope Capacity	: 220m + 220m x 60mm dia synthetics rope @ 9 layers
Recovery (L/M/H)	: 20T@10 m/min 6T@30 m/min
Brake Holding	: 190 tonnes
Anchor Windlass	: 20.5 mm Grade U2 chain pull – 1.8T @ 0~10 m/min
Brake Holding	: 2.7 tonnes
Deck Crane	: Palfinger PK12000M SWL – 1.7T @ 6.1m outreach
Stern Hook	: China make, Disc Type, 70 tonnes SWL

### RADIO AND NAVIGATIONAL EQUIPMENT (GMDSS – A1+A2+A3)

X-Band Radar	: Furuno FAR-1518BB
GMDSS MF/HF SSB Radiotelephone	: Furuno FS-1575 c/w DSC and NBDP
VHF Radiotelephone	: 2 x Furuno FM-8900S w/ DSC
Echo Sounder / Speed Log	: Furuno FE-628
Immarsat C	: Furuno Felcom-18
Navtex Receiver	: Furuno NX-700B
EPIRB	: McMurdo E8
SART	: McMurdo SS
PA/Talkback System	: Furuno LH-5000
Magnetic Compass	: Saura T130VDA, 125mm binnacle
Satellite Compass	: Furuno SC-70
Auto Pilot	: Raytheon Anschutz PilotStar NX
AIS	: Furuno FA-170
GPS	: Furuno GP-39
BNWAS	: Furuno BR 500
Hand-held VHF	: 2 x Entel HT649

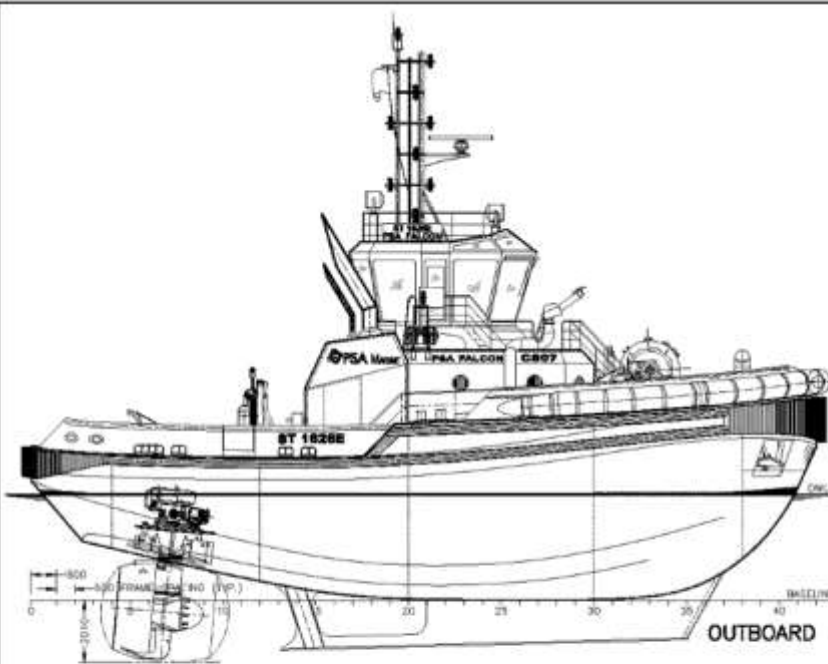

OUTBOARD PROFILE

GENERAL PARTICULARS	
LENGTH, OVERALL	25.40 m
BEAM, MOULDED	11.80 m
DEPTH, MOULDED	4.60 m
DRAFT, DESIGN (ABOVE BL)	3.40 m
DRAFT, MAXIMUM	~5.42 m
INSTALLED POWER	2 x 2000 KW
BOLLARD PULL, AHEAD	70 TONNES
GT	348
COMPLEMENT	8
FUEL	91 m <sup>3</sup>
POTABLE WATER	11 m <sup>3</sup>
CLASS NOTATION	LR #100A1 TUG (ESCORT TOWAGE IN PROTECTED WATERS SERVICE), FIRE-FIGHTING SHIP 1(2400M <sup>3</sup> /HR) WITH WATER SPRAY, *WS, *MC, UMS, UNRESTRICTED SERVICE

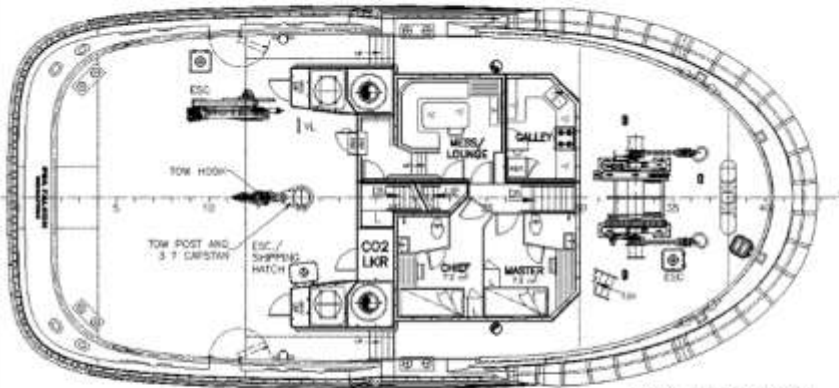

MAIN DECK PLAN

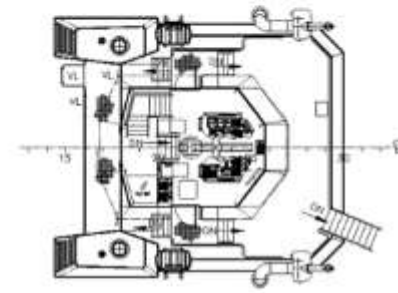

BRIDGE DECK

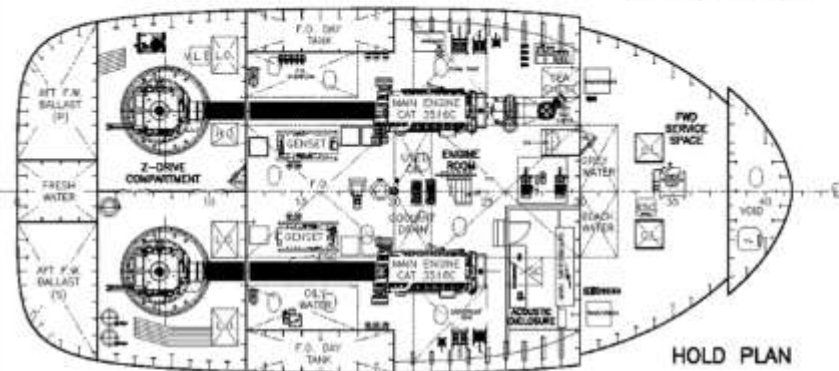

HOLD PLAN

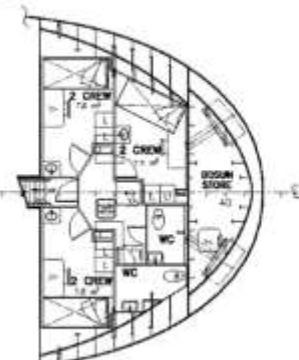

LOWER ACCOMMODATIONS

OWNER	PSA MARINE (PTE.) LTD.	SHIP NAME	PSA FALCON
BUILDER	CHEONG LEE SHIPYARD LTD	VARD No.	6591
CLASS	LLOYD'S REGISTER	MO. No.	9992968
DELIVERY DATE	NOVEMBER, 2025	PORT OF REGISTRY	SINGAPORE

BUILDERS	CHEONG LEE SHIPYARDS LTD 88-91 SUNG ROAD STREET WEST, LAY 138 KEE, KUALA LUMPUR (MALAYSIA) 50050 TEL: (603) 2301 6532 F: (603) 2301 6533
	HIN LEE (ZHUHAI) SHIPYARD CO., LTD. 1 DONGXIN GATE 111, DONGXIN, ZHUHAI, GUANGDONG, P.R.C. TEL: (86) 756 6332665 E-MAIL: zhaoc@hinlee.com

	ROBERT ALLAN LTD. HVAL ARCHITECTS AND MARINE ENGINEERS 230-1838 WEST 2nd AVE. VANCOUVER, B.C.
--	---

VESSEL	<b>Ramparts 2500CL</b> TERMINAL / BERTHING TUG		
CLIENT	PSA MARINE (PTE.) LTD.		
TITLE	GENERAL ARRANGEMENT		
DRAWN BY	CHECKED	APPROVED	SCALE
ZW LAD			A2-1:150
DATE	SHEET	DRG. No.	VARD No.
04 NOV, 21	1 OF 1	HL_5201_30000	5201
			REV
			AS FITTED